

## PRODUCT DESCRIPTION

Pink® Batts® Silencer Mid Floor is a lightweight glass-wool material specifically manufactured for better acoustic performance. Pink® Batts® Silencer Mid Floor is manufactured in plants with ISO 9000 series registration. The manufacturing process is quality controlled to produce product to an assured high standard.

## APPLICATIONS

Pink® Batts® Silencer Mid Floor is designed as a specialist absorption material to the cavity between upper and lower floors (Mid Floor) in typical New Zealand 2 x storey timber or steel framed buildings. It will add excellent absorption to the normally reverberant cavity which when untreated can allow unwanted noise to be transmitted from floor to floor.

## ENVIRONMENTAL

The manufacture of Pink® Batts® Silencer Mid Floor involves a process which uses up to 80% recycled glass. The glass used by Tasman Insulation New Zealand has recently been tested and classified under European Union guidelines as bio-soluble. This means that in the unlikely event of glass fibre getting into the body they will dissolve rapidly and carry no carcinogenic risk.

Tasman Insulation NZ continues to recommend the use of simple protective equipment to stop dust from any source that may have settled in the work area from irritating eyes, nose or throat

## BENEFITS

Improved acoustic privacy, deadening noise transmission such as speech and other background noise.

Improved living environment, providing a more quiet harmonious home

Easily fitted when buildings are under construction - n.b. retro fitting in most cases requires the removal of ceiling linings

Thermally efficient - although primarily used as an acoustical material, Pink® Batts® Silencer Mid Floor has corollary benefits in that it is good thermal insulation

The distinctive grey colour of the product allows specifiers to easily identify the product and guard against substitutes being used

The product is dimensionally stable and is not affected by building movement

## ACOUSTIC PERFORMANCE

Pink® Batts® Silencer Mid Floor has a range of tested absorbency results, which are noted later in this data. Careful fitting of the product will contribute to the successful acoustic performance of the total system. It must be noted any structures acoustic performance will be greatly reduced by any penetrations or openings through it, popular recessed or down lights should be avoided for this reason. Where impact sound is being treated it should be noted good quality heavy grades of carpet with underlay are advised.

Aug 2003	CISfB	35	Rm1	(M)(P)
----------	-------	----	-----	--------



**PINK® BATTS®  
SILENCER  
MID FLOOR**

## GENERAL

Compression of product is not recommended as absorpency performance will be reduced.

Any gaps left by careless installation of product or structural components will allow pathways for sound to pass through, reducing the systems overall acoustic performance.

Splitting wall or floor structures into separate components i.e. staggered or double studs will interrupt noise transmission paths and will help improve acoustic performance.

The effectiveness of structures will be completely lost if penetrations are made from one side to the other and not sealed i.e. electrical, plumbing or light fittings.

### Associated Information.

"A Guide to Home Soundproofing" 2000 Booklet  
"Residential Noise Control:" Video

## EARLY FIRE HAZARD

Pink® Batts® Silencer Mid Floor is designed for use at ambient temperatures and should not be used in conditions where the temperature exceeds 120°C. Where flues or other similar heat emitting items pass through the insulation layer a 150mm gap should be left between that item and the insulation to allow cooling. Glass wool will not burn nor support combustion.

### A.S. 1530 PART 3 1976

Ignitability Index	(0-20)	0
Spread of Flame	(0-10)	0
Heat Evolved Index	(0-10)	0
Smoke Developed Index	(0-10)	0

**Maximum Temperature.**

120°C

Moisture Absorption - Less than 0.2% by volume.

Odours. Glass wool is odourless and will not absorb odours from surroundings.

**Bacteria and Fungus Resistance.** Glass wool does not promote nor sustain bacteria or fungus growth.**Corrosion Resistance.** Does not cause or accelerate corrosion with steel, copper or aluminium.**Shrinkage.** None**Capillarity.** Negligible after 24 hours.**Material Safety Data Sheet.** Available on request.**Distribution.** Tasman Insulation New Zealand will be pleased to advise you on a distributor near you.**INSTALLATION**

Ideally for better acoustic performance battens or a suspended ceiling lining will help increase separation of floor/ceiling components.

This will contribute to reducing sound transmission paths through the structure to areas below.

Pink® Batts® Silencer Mid Floor should be installed carefully minimising gaps (which will allow sound leakage) before the ceiling linings are fixed. This may require temporary support such as Dan Band tape to be stapled to the underside of joists as the product is installed. Permanent support will be provided when ceiling linings are installed.

**SOUND ABSORPTION COEFFICIENTS**

Frequency (Hz)							
	125	250	500	1000	2000	4000	NRC
150mm	0.96	1.18	1.11	1.02	1.12	1.08	1.10

\* For test results and structure details, contact Tasman Insulation New Zealand. (Test No. T0125-4B)

**PACKAGING DETAILS**

Size	Thick	Pieces	Area
Pink® Batts® Silencer Mid Floor 1140 x 432	150	10	4.9m <sup>2</sup>

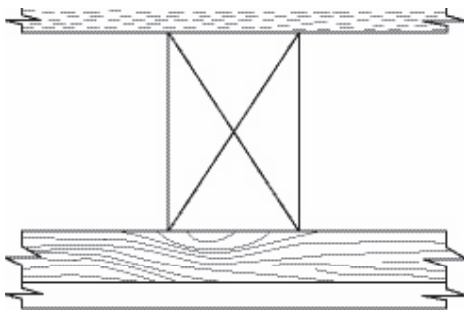
**MID FLOOR 2**

<b>Joists</b>	200 x 50 @ 450mm
<b>Flooring</b>	Particle Board 20mm
<b>Ceiling</b>	9.5mm Plasterboard
<b>Battens</b>	Battens @ 400mm
<b>Infill</b>	No

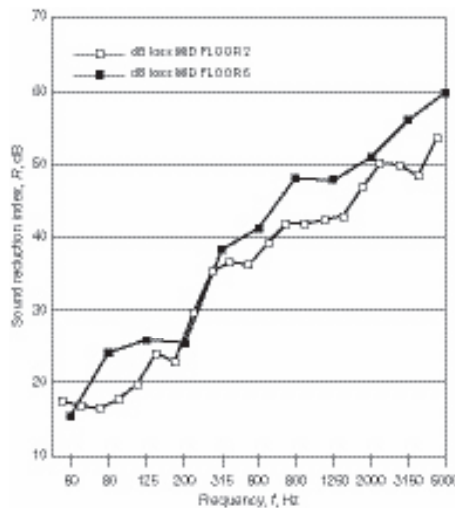
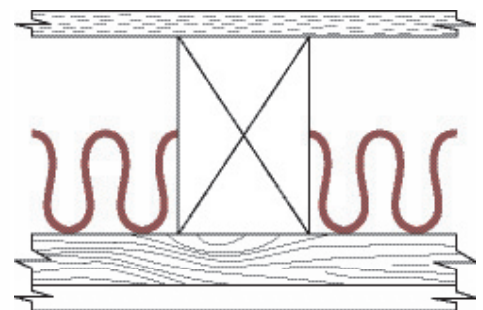
**MID FLOOR 6**

<b>Joists</b>	200 x 50 @ 450mm
<b>Flooring</b>	Particle Board 20mm
<b>Ceiling</b>	10mm Plasterboard
<b>Battens</b>	Battens @ 600mm
<b>Infill</b>	150mm Pink® Batts® Silencer Mid Floor



Visit us at: [www.pinkbatts.co.nz](http://www.pinkbatts.co.nz)  
or email: [pinkbatts@tasbuildpro.co.nz](mailto:pinkbatts@tasbuildpro.co.nz)

**AUCKLAND**

P.O. Box 12069, Penrose, Auckland, New Zealand  
Telephone 09-579 2139, Facsimile 09-579 8806

**CHRISTCHURCH**

P.O. Box 16000, Christchurch, New Zealand  
Telephone 03-349 9059, Facsimile 03-349 4261

**WELLINGTON**

P.O. Box 51-366, Tawa, Wellington, New Zealand  
Telephone 04-232 1576, Facsimile 04-232 1564

\* This brochure supersedes all previous brochures. \* Tasman Insulation New Zealand retain the right to change products and specifications without prior notification. If a specification is critical to the end use, please consult Tasman Insulation New Zealand. \* This information is provided without prejudice to Tasman Insulation New Zealand standard terms and conditions of sale.