

PRÎMA*liner*TM

Features



PRIMA^{lin}er

Smooth Lining for Walls and Ceilings

Immune to Permanent Moisture Damage

Applications:

Internal Drywall (Wet Area System, Sound Rated System, Fire-Rated System)

A premium quality fibre cement board with square rebated edges for flush jointed internal walls.

The continuous quest for better value for money and improvement are very common objectives. Now you have the comfort of knowing that the **PRIMA^{lin}er™** you have chosen will provide the on-going high performance and durability requirements.

PRIMA^{lin}er™ is a high quality, high impact, fire resistant, fibre cement lining board ideal for walls in both domestic and commercial construction.

Product Benefits

- Immune to Permanent Moisture Damage
- High Impact Strength
- Termite Resistant
- Fire Resistant
- Climate-Friendly
- Good Sound Insulation

Material Properties & Composition

Material & Application Specifications

Sizes (mm)	1220mm x 2440mm		
Thickness (mm)	6	9	12
Mass per sheet (kg)	25.22	37.23	51.19
Sound Transmission Loss (dB)	25	28	30

Application Requirements/ Thickness	6mm	9mm	12mm
Ceiling Lining	•	•	•
Wall Lining	•	•	•
Fire-Rated Wall	•	•	•



Properties

Values

Product Composition	<ul style="list-style-type: none">• Top Grade Cellulose Fibre• Finely Ground Sand• Portland Cement• Water
Nominal Density	EMC=1390kg/m ³
Moisture Movement at EMC	Approximately 7%
Moisture Movement (from EMC to saturated)	0.06%
Thermal Conductivity, k Value	0.30W/mK
Thermal Insulation, R Value	6.0mm - 0.030 m ² K/W 9.0mm - 0.045 m ² K/W
Flexural Strength at EMC	14 MPa Dry 8 MPa Wet
Fire Resistant	Class O (BS 476: Part 6 and BS 476: Part 7)

Note: Where values are stated at EMC, the Ambient Temperature is 27° C± 2° C and Relative Humidity is between 65% - 95%.

Framing Requirement

Framing & Fixing Specifications

Support Framing Centre Distance (mm)

Stud/ joist spacing	610mm maximum
Nogging spacing	1220mm maximum
Support face width:	50mm minimum (timber) 36mm minimum (steel)

The table stipulates the minimum framing requirement. It is a good building practice to provide equal support spacing not exceeding the recommended centre distance to suit the sheet size. In all cases sheet edges must be supported.

Timber framing should be thoroughly selected and dried to minimize shrinkage when boards are installed. Steel frame thickness should be 0.50mm base metal thickness (BMT) to 1.55mm BMT.

**** Please refer to HCI technical department for further detail.**

PRIMA^{liner}™ may be fixed to either timber or steel framing. The fastener specifications and fixing distance shall be in accordance with Table T1 & T2.

Table 1: Fastener Specifications

Table below show the suitable type of the fastener on the right framing:

Fixing to Timber Support

Galvanised Fibre Cement Nails
(for fixing to softwood and hardwood)



- 2.8mm ϕ x 30mm for softwood
- 2.0mm ϕ x 25mm for hardwood

Fixing to Steel Support

(0.50 – 0.75) mm BMT - Screw with no Wingteks
(0.75 – 1.15) mm BMT - Screw with Wingteks

Self-Embedding head,
Self-Drilling and reamer point screws
(for fixing to light gauge steel frame)



- 8 gauge - #18 x 25mm long to fix 6mm board
- 8 gauge - #18 x 30mm long to fix 9mm board & 12mm board

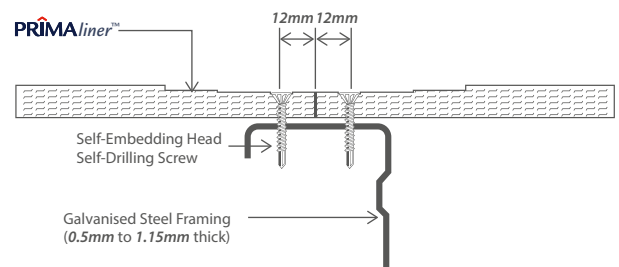

Fastener Fixing Detail Figure

Note:

1. Screw fixing is only suitable for 6mm thick board and above.
2. Screw head must be embedded 0.5mm below board surface.
3. Nails and screw must be suitable coated for the intended applications

All nails shall comply with 'AS 2334: 1980 - STEEL NAILS - METRIC SERIES' or equivalent standard.

All screws shall comply with 'AS 3566: 1988; SCREWS - SELF DRILLING - FOR THE BUILDING AND CONSTRUCTION INDUSTRIES' or equivalent standard.

Table 2: Fastener Fixing Distance

Fastener Fixing Distance For Untiled Wall	Fastener Fixing Distance For Tiled Wall & Fire Rated Wall
12mm minimum from edges	12mm minimum from edges
50mm minimum from corners	50mm minimum from corners
200mm centres spacing along edges	200mm centres spacing along edges
300mm centres spacing elsewhere	200mm centres spacing elsewhere

Flush Joint Wall Applications

PRIMA^{liner}™ sheets must be fixed horizontally (Figure L1) or vertically (Figure L2), ensuring the vertical sheet joint on one side of the stud does not coincide with the vertical sheet joint on the other side to further enhance the stability of the wall.

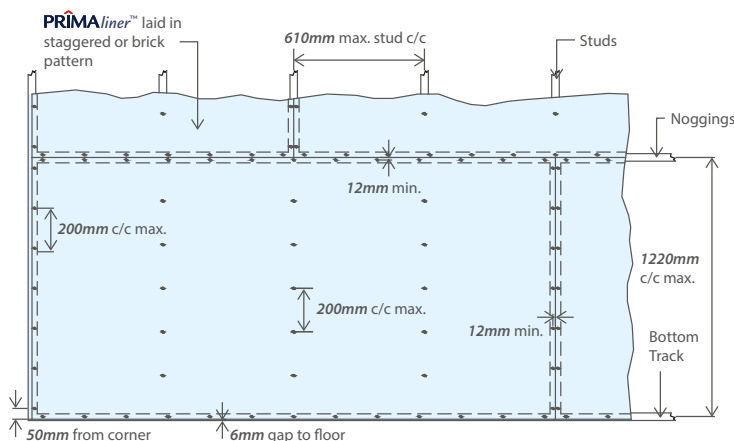

Horizontal Sheet Fixing = Figure L1

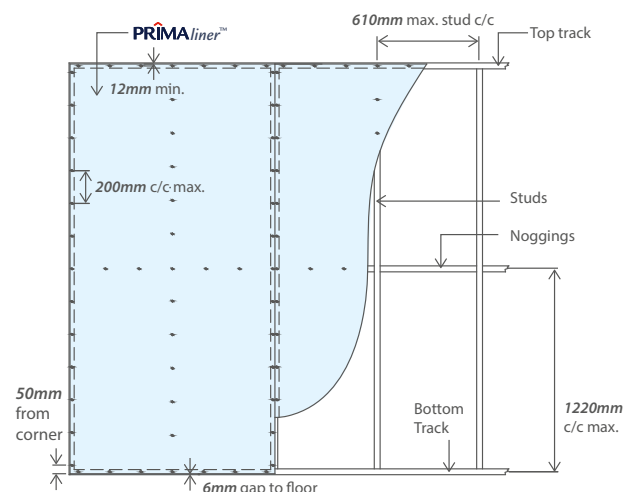

Vertical Sheet Fixing - Figure L2

Note: **PRIMA^{liner}**™ sheets must be fixed with a clearance gap of 6mm from ground floor surface.

Flush Joint Ceiling Applications

1. Installation Specification

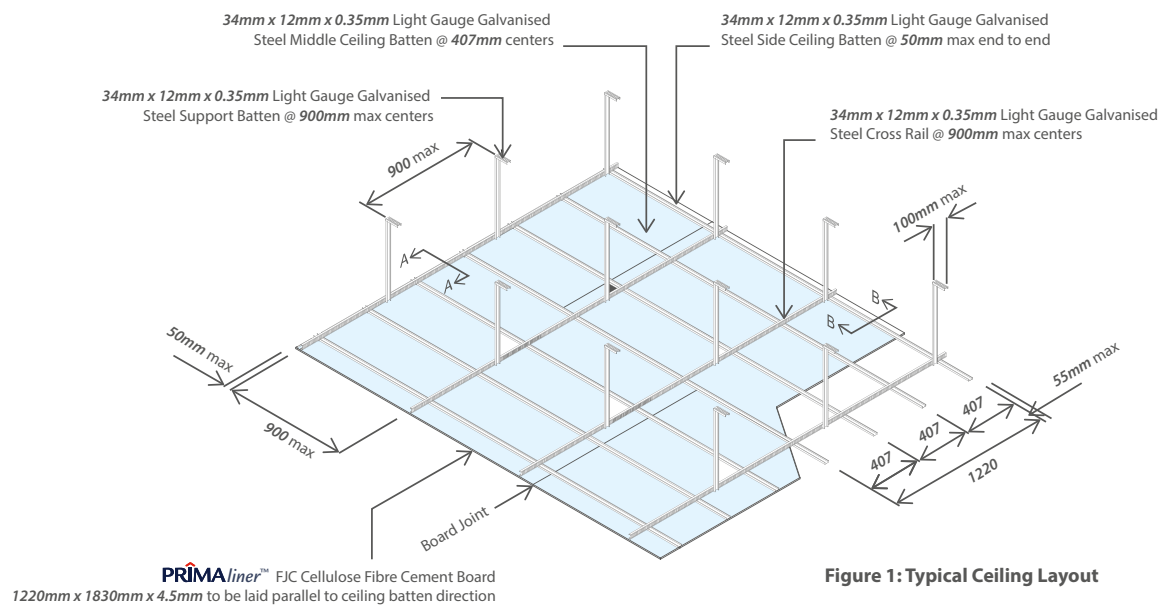

Figure 1a: A' - A' Section Detail

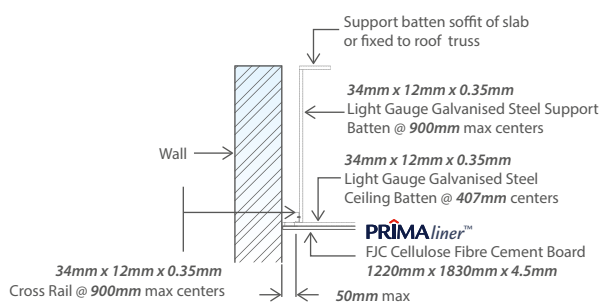
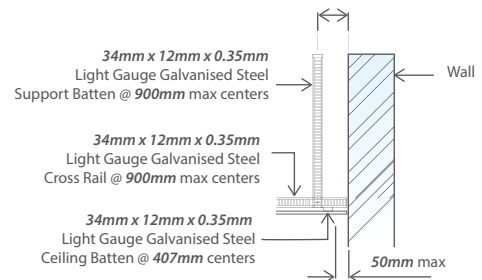

Figure 1b: B' - B' Section Detail



2. Board Installation

Board shall be in staggered pattern arrangement

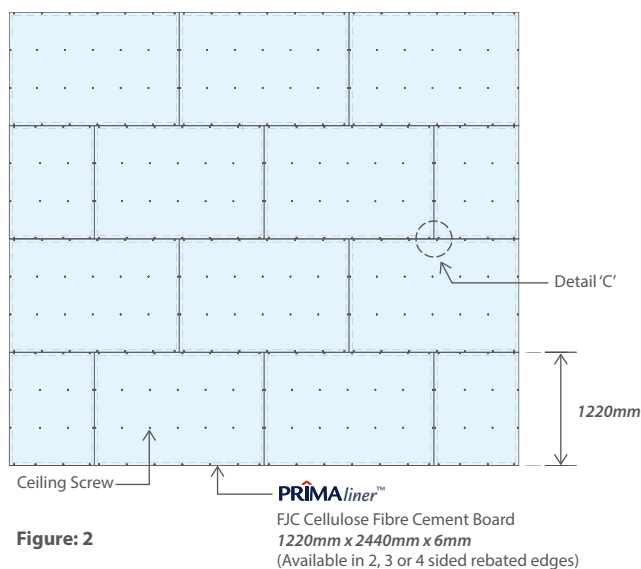
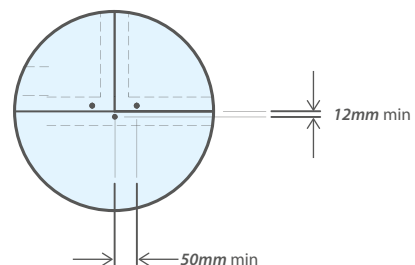

Figure: 2a DETAIL 'C'



3. Fastener Fixing Distance

Place fasteners 12mm from board edges and 50mm from corners. Fasteners must be spaced maximum 300mm centres at the board perimeter and intermediate framing.

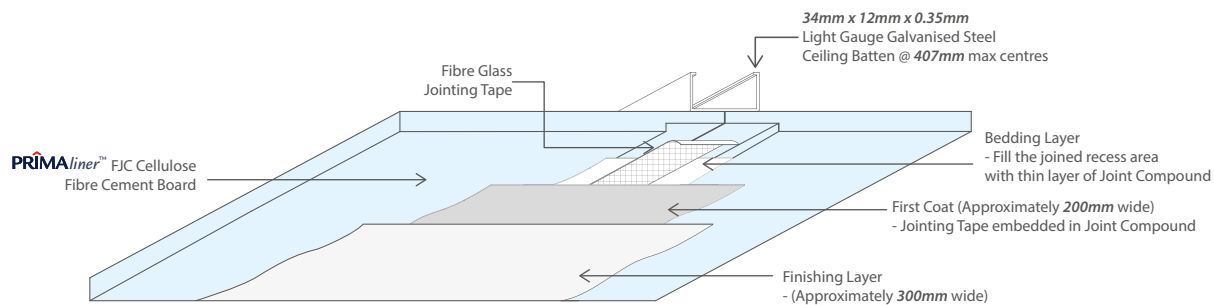

Figure 3: Flush Joint Detail

4. Flush Joint Detail

Board joint can be treated by incorporating the Perforated Paper Jointing Tape and Gypsum Joint Compound. Best result can be achieved when both board edges have recesses. If it becomes necessary to flush set over no recessed edges, the Bedding Layer, First Coat and Finishing Coat should be broadened to fill the joined **200mm** and **300mm** respectively. Lightly sand the Board Joint when dry to get a smooth finish before painting.

5. Painting

After the sanding process, the board must be painted with a minimum of 2 layers water-based Acrylic Paint. Make sure the board surface is in smooth condition and free from dust or any contaminant.

6. Access Panel Detail

Two sizes are available: **300mm x 300mm** and **450mm x 450mm**.
(Please refer to HCl for further information.)

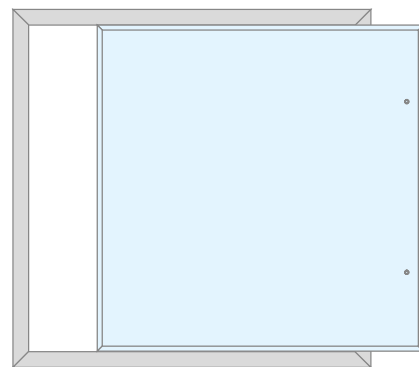

Figure 4: Access Panel Detail

7. Expansion Joint Detail

Expansion Joint should be provided at every **9000mm** c/c formed using Heels with square cut edges. Provide an approximately **6mm** wide gap between sheets and seal with paintable flexible Sealant. Do not apply Jointing Compound at the expansion joint.

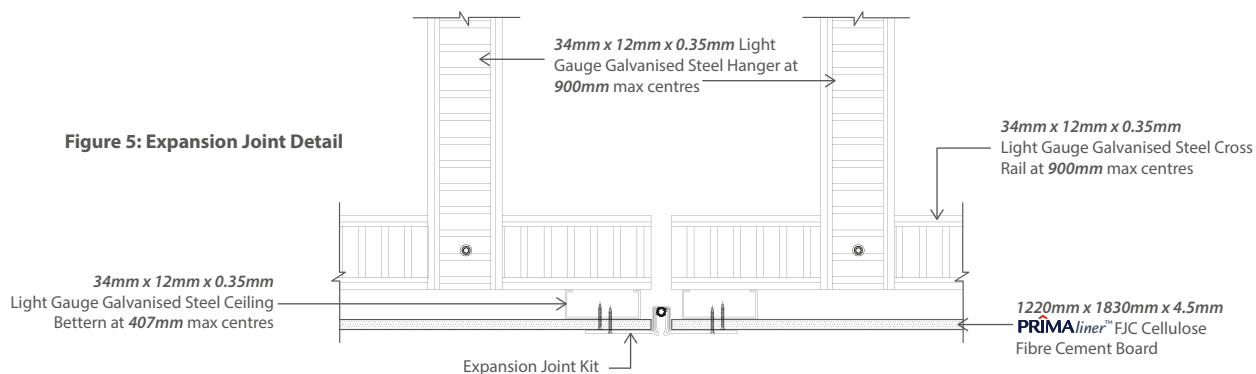
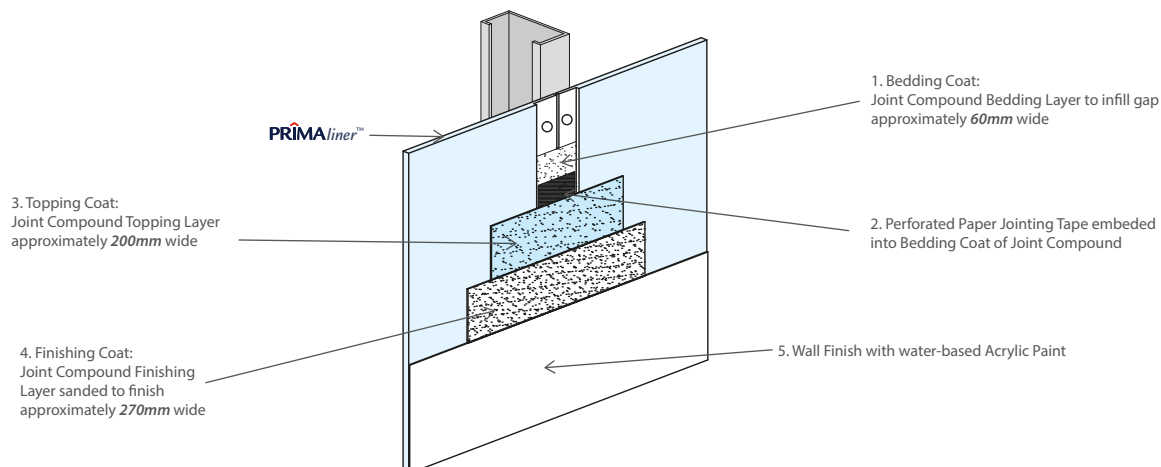

Figure 5: Expansion Joint Detail



Handling & Finishing

All **PRIMA^{liner}**™ boards must be stacked flat, off the ground, and supported on a level platform. Care must be taken to avoid damage to edges, ends and surfaces. Material must be kept dry, preferably by being stored inside a building. Where it is necessary to store material outside, it must be protected from the weather.

Storage

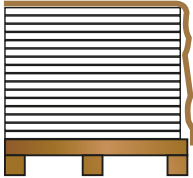

- Store sheets neatly on a flat surface supported evenly with bearers spaced at **600mm** centres maximum, clear of the ground to avoid damage and moisture ingress.
- Store under cover and ensure sheets are dry prior to fixing. Never install damp sheets. Damp Sheets must be allowed to dry to equilibrium moisture content (EMC) before fixing.

Handling

- Always ensure at least 2 persons are lifting the board at the same time in an upright position.
- Do not hold on each end on edge.
- Exercise care when handling **PRIMA^{liner}**™ to avoid damaging the corner.

Cutting

The following methods may be used for cutting **PRIMA^{liner}**™ boards:

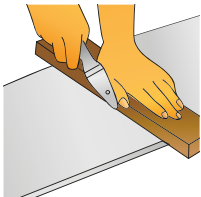

Score & Snap

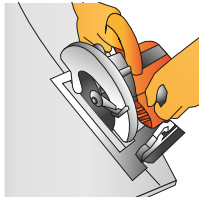

Saw Cut

Notching & Penetrations



Notching



Forming Round Hole

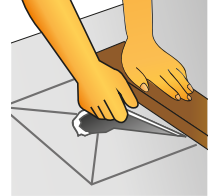

Forming Rectangular Hole

Finishing



Paint



Wall Covering



Texture Coating

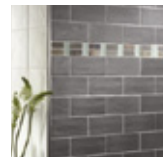

Tiles

PRIMA^{liner}™ can be decorated with 2 coats of 100% quality water-based acrylic paint. For general-purpose applications, there is no requirement for primers or sealers. Please refer to paint manufacturer for advice.

Alternatively, the sheet surface can be decorated with wall covering materials, such as wall paper. In all cases, coating manufacturer's recommendations must be strictly adhered to. For wet area application, tile finishing may be preferable.



PRIMA^{liner}™



Termite Resistant



Fire Resistant



Water Resistant



Weather Resistant



Environmentally Friendly



Superior Paint Adhesion



High Workability



Aesthetically Pleasing



50 Years Durability

WARRANTY

Hume Cemboard Industries Sdn Bhd ("the Company") warrants that it will at all times ensure that the products referred to herein ("the Products") shall be supplied by it to the purchaser free of any manufacturing defects and defective materials used in their manufacture.

In the event and if contrary to this assertion the Products prove to be defective, whether as a result of manufacturing defects or arising from the Company's use of defective materials, the Company will supply replacement Products. The Company shall, however, have the option and may choose to reimburse the purchaser the purchase price of the Products instead. The Company shall not be liable for any economic or consequential losses arising from any use of defective Products.

This warranty shall be void unless the purchaser has, in its handling and installation of the Products, complied with the recommendations contained in this brochure and other good building practices expected of a reasonable purchaser.

ADVISORY NOTE

Successful installations of Hume Cemboard Industries Sdn Bhd's Products depend on a large number of factors that are outside of the scope of this brochure. Particular design, detail, construction requirements and workmanship are beyond the control of the Company. As such, Hume Cemboard Industries Sdn Bhd's warranty does not extend to non-usability of Products or damage to Products arising from poor or defective designs or systems or poor quality of workmanship in the installation of Products.