



**PRIMA** *flex*<sup>TM</sup>

## Features



# PRIMAflex™

## Multi Functions Board

### Applications:

Wall Cladding, Partition, Ceiling/ Eaves/ Soffit Lining, Flooring, Roof Sarking, Water Tank Support & Permanent Formwork

PRIMAflex™ is an eco-friendly multipurpose fibre cement board that can be used for both internal & external applications. It is the first choice in flat sheets among industry professionals.

PRIMAflex™ performs exceedingly well when all aspects of good design detail and workmanship are met. PRIMAflex™ unique combination of physical and mechanical properties make it superior to other building boards:

### Product Benefits

- Strong & Durable
- Fire-Resistant
- Versatile Application
- High Resistant to Decay, Rodent and most Chemicals
- Smooth, Flat & Uniform Surface
- Good Sound Insulation
- Termite Resistant
- User Friendly
- Cost Effective
- Asbestos Free
- Light Weight
- Dimensionally Stable

## Material Properties & Composition

### Applications and Standard Sizes

| Application                         | PRIMAflex™ Sheet Thickness (mm) |     |     |     |     |      |      |      |      |
|-------------------------------------|---------------------------------|-----|-----|-----|-----|------|------|------|------|
|                                     | 3.2                             | 4.5 | 6.0 | 7.5 | 9.0 | 12.0 | 16.0 | 24.0 | 32.0 |
| Ceiling, Eaves & Soffit Linings     | •                               | •   | •   |     |     |      |      |      |      |
| Wall Cladding (Internal & External) |                                 |     | •   | •   | •   | •    |      |      |      |
| Partition                           |                                 |     | •   | •   | •   | •    |      |      |      |
| Flooring                            |                                 |     |     |     |     |      | •    | •    | •    |
| Roof Sarking                        |                                 |     | •   | •   | •   | •    | •    | •    | •    |
| Acoustic Screens                    |                                 |     | •   | •   | •   | •    | •    | •    | •    |
| Swiflet House                       | •                               | •   | •   | •   | •   | •    | •    | •    | •    |
| Water Tank Support                  |                                 |     |     |     |     | •    | •    | •    | •    |
| Permanent Formwork                  |                                 |     |     |     |     | •    | •    | •    | •    |

### Properties

### Values

|                                |   |
|--------------------------------|---|
| Product Composition            | <ul style="list-style-type: none"> <li>• Top Grade Cellulose Fibre</li> <li>• Finely Ground Sand</li> <li>• Portland Cement</li> <li>• Water</li> </ul> |
| Nominal Density                | EMC=1390kg/m <sup>3</sup>   |
| Moisture Content               | EMC=7%  |
| Moisture Content at Saturation | 33%   |
| Minimum Bending Strength, MoR  | Dry=16MPa; Wet=10MPa  |
| Fire Rating                    | Class O (BS 476.6 & BS 476.7)   |
| Fungus Resistance              | Passes (ASTM G 21)  |
| Termite Resistance             | Resistance to Damage (Field evaluation conducted by CSIRO)  |
| Frost Resistance               | Passed (AS/NZS 2908.2, MS 1296)   |
| Surface Coating                | Pre-Primed available  |

### Mass per sheet (kg)

| Sizes (mm)  | Thickness (mm) |      |      |      |      |      |      |       |       |
|-------------|----------------|------|------|------|------|------|------|-------|-------|
|             | 3.2            | 4.5  | 6.0  | 7.5  | 9.0  | 12.0 | 16.0 | 24.0  | 32.0  |
| 610 x 1220  | 3.3            | 4.8  | 6.3  | -    | -    | -    | -    | -     | -     |
| 1220 x 1220 | 6.6            | 9.5  | 12.6 | -    | -    | -    | -    | -     | -     |
| 1220 x 2440 | -              | 19.1 | 25.3 | 31.9 | 37.3 | 49.7 | 66.3 | 107.0 | 142.7 |

\*\* Sound Transmission Loss (Estimated based on mass)

23dB 26dB 28dB 30dB 31dB 32dB 34dB

### Suspended Ceilings

| Support Grid Dimension (mm) | PRIMAflex™ Sheet Size (mm) |
|-----------------------------|----------------------------|
| 600 x 600                   | 595 x 595                  |
| 610 x 610                   | 603 x 603                  |
| 600 x 1200                  | 595 x 1195                 |
| 610 x 1220                  | 603 x 1213                 |

# Applications

## PRIMAflex™ for Every Requirement

PRIMAflex™ sheets comply with the MS1296 specifications for fibre cement flat sheets.



### Ceiling, Eaves & Soffit Linings

PRIMAflex™ offers versatility and high workability.

Recommended thickness:  
3.2mm, 4.5mm & 6.0mm



### Flooring

PRIMAflex™ makes remarkably impact-resistant and hard-wearing floors.

Recommended thickness:  
16.0mm



### Wall Cladding (Internal & External)

PRIMAflex™ is suitable for wall claddings, both internal and external. Economical and durable.

Recommended thickness:  
6.0mm - 12.0mm



### Permanent Formwork

PRIMAflex™ is ideal for heavy duty applications such as permanent formwork. By using fibre cement formwork, the challenges of conventional formwork can be overcome, such as the use of plywood, difficulty and costliness in erecting scaffolding and rough surface finishing.



### Water Tank Support

PRIMAflex™ with high durability, plus its superior resistance to water, mould and termites, also make PRIMAflex™ the ideal material for water tank support.

Recommended thickness:  
12.0mm & 16.0mm



### Roof Sarking

With the exceptional heat-insulation, sound-insulation and water-resistance properties, PRIMAflex™ is the preferred choice for roof sarking application.

Recommended thickness:  
6.0mm - 16.0mm



### Partition & Pocket Wall

PRIMAflex™ with its superior impact-resistance, fire-resistance and sound insulation properties.

Its amazing resistance to water and mould also make it better than either plywood or gypsum, especially for areas with adjoining bathrooms and kitchens, or in situations where the exposure to moisture is high.

Recommended thickness:  
6.0mm - 16.0mm

## Framing Requirements

PRIMAflex™ sheets are suitable for fixing to timber or light gauge steel framing members. Construction of framing shall be in accordance with good local building practice.

| Sheet Thickness | Support Framing Centre Distance (mm) |         | External Cladding |         | Flooring |
|-----------------|--------------------------------------|---------|-------------------|---------|----------|
|                 | Joist                                | Trimmer | Stud              | Nogging | Joist    |
| 3.2mm           | 610                                  | 610     | -                 | -       | -        |
| 4.5mm           | 610                                  | 610     | 610               | 1220    | -        |
| 6.0mm & above   | 610                                  | 1220    | 610               | 1220    | 305/407  |

## Framing & Fixing Specifications

The above table stipulates the minimum framing requirements. It is a good building practice to provide equal support spacing not exceeding the recommended centre distance to suit the sheet size. In all cases sheet edges must be supported.

Support face width:-

- Timber - 50mm minimum
- Steel - 36mm minimum

Timber framing should be thoroughly selected & dried to minimize shrinkage when boards are installed. Steel frame thickness should be 0.75mm base metal thickness (BMT) to 1.55mm BMT.

*\*\*Please refer to HCl technical department for further detail.*

## Fastener Specification

Table below show the suitable type of the fastener on the right framing:

### Fixing to Timber Support

Galvanised Fibre Cement Nails



- 2.0mmØ x 25mm for 3.2mm and 4.5mm thick boards
- 2.0mmØ x 30mm for 6.0mm and 7.5mm thick boards
- 2.0mmØ x 40mm for 9.0mm and 12.0mm thick boards

### Fixing to Steel Support

(0.75mm to 1.55mm Base Metal Thickness)

Self-Embedding head, Self-Drilling Screws



- No. 8 x 7/8" for 6.0mm thick board onwards boards
- No. 8 x 1-1/8" for 12.0mm thick board onwards boards

*Other type of screws may also be suitable, but method of application could vary. Refer to screw manufacturer for proper recommendation.*

### Fastener Fixing Distance

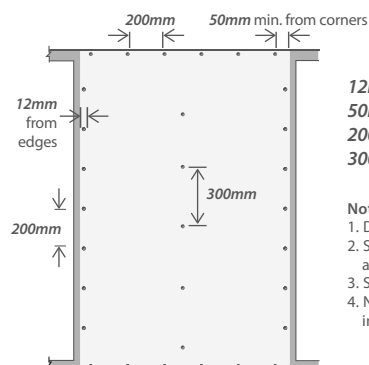

- 12mm min. from edge
- 50mm min. from corner
- 200mm centres max. at sheet perimeter
- 300mm centres max. elsewhere

Note:

1. Drive nail head flush with board surface.
2. Screw fixing is only suitable for 6mm thick board and above.
3. Screw head must be embedded below board surface.
4. Nails and screw must be suitable coated for the intended applications.

# Handling & Finishing

## Storage

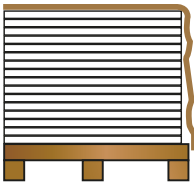

- Store sheets neatly on a flat surface supported evenly with bearers spaced at **600mm** centres maximum, clear of the ground to avoid damage and moisture ingress.
- Store under cover and ensure sheets are dry prior to fixing. Never install damp sheets. Damp Sheets must be allowed to dry to Equilibrium Moisture Content (EMC) before fixing.



## Handling

- Always ensure at least 2 persons are lifting the board at the same time in an upright position.
- Do not hold on each end on edge.
- Exercise care when handling **PRIMAflex™** to avoid damaging the corner.

## Cutting

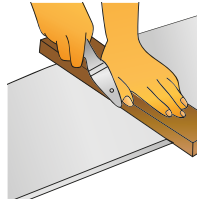

Score & Snap

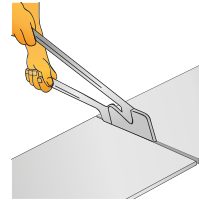

Hand Guillotine

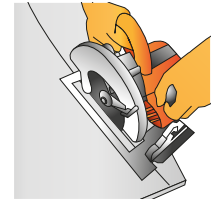

Saw Cut

## Notching & Penetrations

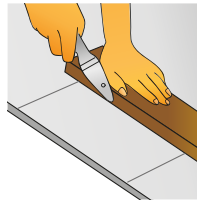

Notching

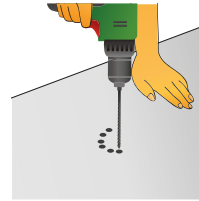

Forming Round Hole

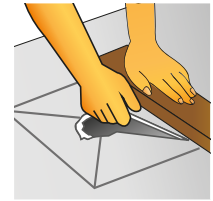

Forming Rectangular Hole

## Finishing



In order to achieve excellent aesthetic finishing, it is recommended to use 100% water-based quality Acrylic Paints. Generally a minimum of 2 coats is required. There is no need to apply Primers or Sealers. Please refer to paint manufacturer's install cases.



All **PRIMA<sup>liner</sup>™** products come with a solid 10-year warranty on any defects or irregularities in its products.



Termite Resistant



Fire Resistant



Water Resistant



Weather Resistant



Environmentally Friendly



Superior Paint Adhesion



High Workability



Aesthetically Pleasing



50 Years Durability

### WARRANTY

Hume Cemboard Industries Sdn Bhd ("the Company") warrants that it will at all times ensure that the products referred to herein ("the Products") shall be supplied by it to the purchaser free of any manufacturing defects and defective materials used in their manufacture.

In the event and if contrary to this assertion the Products prove to be defective, whether as a result of manufacturing defects or arising from the Company's use of defective materials, the Company will supply replacement Products. The Company shall, however, have the option and may choose to reimburse the purchaser the purchase price of the Products instead. The Company shall not be liable for any economic or consequential losses arising from any use of defective Products.

This warranty shall be void unless the purchaser has, in its handling and installation of the Products, complied with the recommendations contained in this brochure and other good building practices expected of a reasonable purchaser.

### ADVISORY NOTE

Successful installations of Hume Cemboard Industries Sdn Bhd's Products depend on a large number of factors that are outside of the scope of this brochure. Particular design, detail, construction requirements and workmanship are beyond the control of the Company. As such, Hume Cemboard Industries Sdn Bhd's warranty does not extend to non-usability of Products or damage to Products arising from poor or defective designs or systems or poor quality of workmanship in the installation of Products.



A Member of the Hong Leong Group

No. 12 Jalan Tandang, 46050 Petaling Jaya, Selangor, Malaysia.

Malaysia Sales Tel: +603 7625 9999 Fax: +603 7625 7822 Email: sales@humecemboard.com.my

Oversea Sales Tel: +603 7625 3880 Fax: +603 7625 3990 Email: exportHCl@humecemboard.com.my

www.primafibrement.com