

how  
to

# Fix Bestwood® Ply - Wood Framing

Guarantees a fast secure bond!

**HOLDFAST**  
Right First Time!

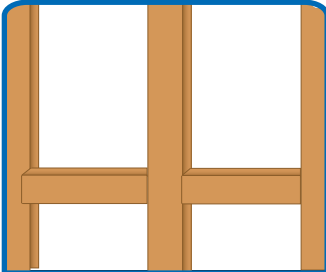

### STEP 1

Clean non porous surface by wiping with Holdfast® 696 Surface Activator.

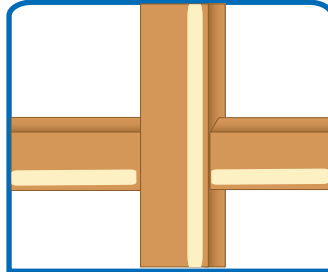

### STEP 2

Apply Gator® Auto / Panel Double Sided Tape to frame.

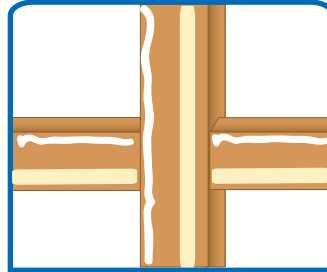

### STEP 3

Apply 5mm x 5mm continuous bead of FixAll® 220 Sealant using a Gorilla® Pro Gun.

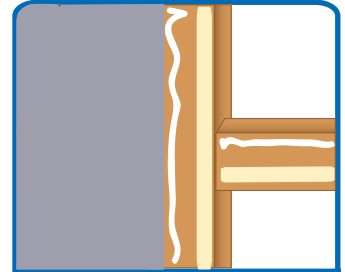

### STEP 4

Gently press the Bestwood® Ply panel against adhesive\* to join.\*\* Allow 24 hours for full cure.

\*\*Roll or press firmly over all areas of framing to ensure consistent contact between the Bestwood® Ply panel, the Gator® Auto/Panel Double Sided Tape and FixAll® 220 Sealant.

## ... why FixAll® 220 Sealant?

FixAll® 220 Sealant is a high performance MS sealant, with superior flexibility. Guaranteed to stick!



- ✓ Guaranteed low VOC content
- ✓ Guaranteed for use on expansion joints
- ✓ Guaranteed for interior and exterior use
- ✓ NO RISKS, TRUST FixAll 220 Sealant, Guaranteed to work!

## ... what you need

425gm (#20067)  
600ml (#20073)



FixAll® 220 Sealant



500ml (#19389)



Holdfast® 696  
Surface Activator



#21104  
or  
#21116 (Sausage Gun)



FixAll® MS Gun



12mm x 1mm x 33m (#11711)



Gator® Auto / Panel  
Double Sided Tape

## GUARANTEED NO RISK!

\*NOTE: This information is intended as a guide only. If you are unsure please contact us for more detail. No responsibility will be accepted for incorrect installation. Test is best. Please refer to technical datasheet on our website. [www.holdfast.co.nz](http://www.holdfast.co.nz)

  
**Brett Henderson**  
Managing Director, Holdfast NZ Ltd

[www.holdfast.co.nz](http://www.holdfast.co.nz)

14 Avalon Drive, SH 1, Nawton 3200  
PO Box 4206, Hamilton East 3247  
Hamilton, New Zealand  
Ph: (07) 8475540, Fax: (07) 847 0324

# how to

## Fix Bestwood® Ply - Metal Framing

Guarantees a fast secure bond!

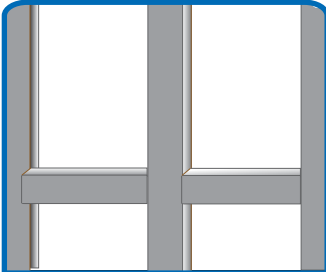

### STEP 1

Clean non porous surface by wiping with Holdfast® 696 Surface Activator.

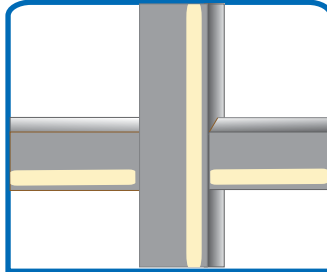

### STEP 2

Apply Gator® Auto / Panel Double Sided Tape to frame.

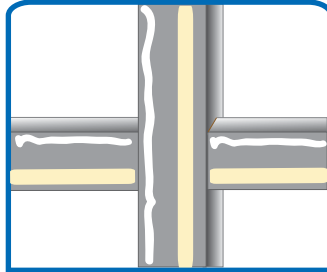

### STEP 3

Apply 5mm x 5mm continuous bead of FixAll® 220 Sealant using a Gorilla® Pro Gun.

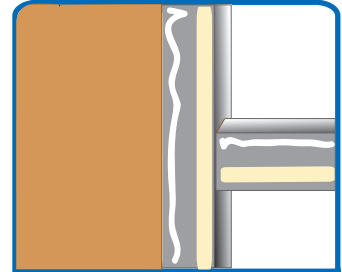

### STEP 4

Gently press the Bestwood® Ply panel against adhesive\* to join.\*\* Allow 24 hours for full cure.

\*\*Roll or press firmly over all areas of framing to ensure consistent contact between the Bestwood® Ply panel, the Gator® Auto/Panel Double Sided Tape and FixAll® 220 Sealant.

## ... why FixAll® 220 Sealant?

FixAll® 220 Sealant is a high performance MS sealant, with superior flexibility. Guaranteed to stick!



- ✓ Guaranteed low VOC content
- ✓ Guaranteed for use on expansion joints
- ✓ Guaranteed for interior and exterior use
- ✓ NO RISKS, TRUST FixAll 220 Sealant, Guaranteed to work!

## ... what you need



**GUARANTEED NO RISK!**

\*NOTE: This information is intended as a guide only. If you are unsure please contact us for more detail. No responsibility will be accepted for incorrect installation. Test is best. Please refer to technical datasheet on our website. [www.holdfast.co.nz](http://www.holdfast.co.nz)

**Brett Henderson**  
Managing Director, Holdfast NZ Ltd

[www.holdfast.co.nz](http://www.holdfast.co.nz)

14 Avalon Drive, SH 1, Nawton 3200  
PO Box 4206, Hamilton East 3247  
Hamilton, New Zealand  
Ph: (07) 8475540, Fax: (07) 847 0324